

The details shown on this drawing are confidential and the drawing is the exclusive property of Halliday Clark Limited. No use, copy or disclosure of the drawing may be made without our permission and it is to be returned to Halliday Clark Limited when required. Halliday Clark Limited takes no responsibility for the use of this drawing for any purpose other than for that which it was intended. All dimensions are in millimeters unless stated otherwise. All dimensions should be verified on site prior to commencement of works. Do not scale from this drawing. All works must be in accordance with British Standards, EC Standards, Health & Safety at work act & all other relevant regulations & Bye Laws. Any discrepancies should be brought to the attention of Halliday Clark Limited.

NOTES

NOTES:
DO NOT SCALE FROM DRAWING.

AREA SCHEDULE
SITE 1 AREA - 2540m²
- 0.25 Hectares
- 0.62 Acres

APARTMENTS
Type 1
2Bed 3P 62 sq.m / 667sq.ft 4 No.

BUNGALOWS
Type 2
2Bed 3P 62 sq.m / 667sq.ft 4 No.
Total 8 No.

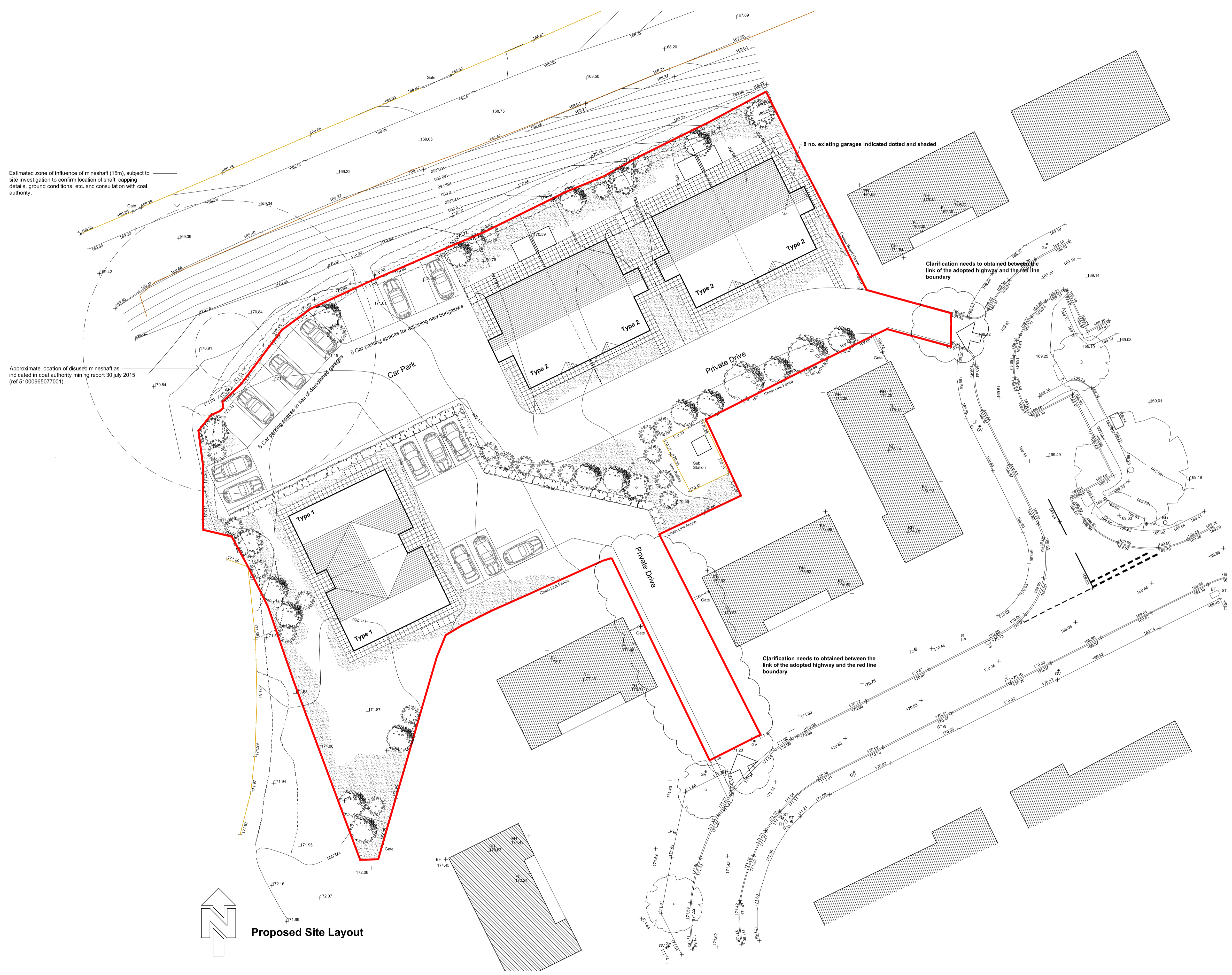

Proposed Site Layout

A - 29.12.2015	SE
BUNGALOWS REDUCED IN SIZE AND EXTRA INFORMATION ADDED	
OCTOBER 2015	SE DCH
INITIAL ISSUE	
REVISION - DATE	DRWN CHKD

FOR COMMENT

**MAES Y MEILLION
LEESWOOD**

**FOR
WATES LIVING SPACE**

**PROPOSED SITE LAYOUT
SCHEME 7**

Scale 1:100 & 1:200 @ A1

**HALLIDAY CLARK
ARCHITECTS**

Halliday Clark Limited T 01274 589 888
Salts Wharf F 01274 589 922
Ashley Lane E info@hallidayclark.co.uk
Shipley BD17 7DB W hallidayclark.co.uk